



Solarfun
林洋

SF- TOPCon DN66G3-2



N-Type Double-glass Bifacial Half-cell Solar Module

Maximum Power Output **625W**

Maximum Module Efficiency **23.14%**

Power Tolerance **0~+5W**



Ultra-high Power Output

- Power output up to 625W
- Additional power generation gain up to 30%



Outstanding Weather Resistance

- Dual-glass design, with a broader application range
- Suitable for use in deserts, farms and near coastal areas
- Front side can withstand a load of 5400 Pa, and the back side can withstand a load of 2400 Pa



Higher Power Generation Gain

- Lower first-year degradation rate (1%) and annual degradation rate (0.4%)
- Half-cell technology reduces localized power loss
- Lower temperature coefficient and operating temperature, leading to more power generation



Safe and Reliable

- Class C fire resistance test passed
- IP68 ensures long-term reliability
- New generation TOPCon technology, with no wraparound coating, no leakage, and low hot spot risk

Industry-leading linear warranty

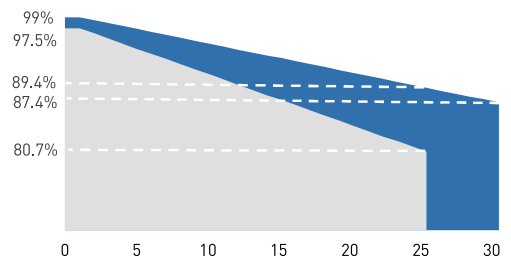

1%

First year degradation

0.4%

Annual degradation

15 Year Product Warranty

30 Year Linear Power Output Warranty

Note :
Certificate holder: Jiangsu Liyang Photovoltaic Technology Co., LTD.
Country of Solar Module manufacture : China



Electrical Parameters (STC)

Maximum Power	P _{max} (W)	595	600	605	610	615	620	625
Open Circuit Voltage	V _{oc} (V)	47.14	47.33	47.57	47.76	48.00	48.19	48.43
Short Circuit Current	I _{sc} (A)	15.70	15.76	15.82	15.88	15.94	16.00	16.06
Maximum Power Voltage	V _{mp} (V)	40.18	40.38	40.58	40.78	40.98	41.18	41.38
Maximum Power Current	I _{mp} (A)	14.82	14.87	14.92	14.97	15.02	15.07	15.12
Module Efficiency	(%)	22.03	22.21	22.40	22.58	22.77	22.95	23.14

* Irradiance 1000W/m², Cell Temperature 25°C, Air Mass 1.5, Testing Tolerance ±3%

Electrical Specification (NOCT)

Maximum Power	P _{max} (W)	447	451	455	459	462	466	470
Open Circuit Voltage	V _{oc} (V)	44.78	44.96	45.19	45.37	45.60	45.78	46.01
Short Circuit Current	I _{sc} (A)	12.68	12.73	12.77	12.82	12.87	12.92	12.97
Voltage at Maximum Power	V _{mp} (V)	37.44	37.62	37.81	37.99	38.18	38.37	38.55
Current at Maximum Power	I _{mp} (A)	11.96	12.00	12.04	12.08	12.12	12.16	12.20

Electrical Characteristics with Different Power Bin (Reference to 15% Irradiance Ratio)

Maximum Power	P _{max} (W)	684	690	696	702	707	713	719
Open Circuit Voltage	V _{oc} (V)	47.14	47.33	47.57	47.76	48.00	48.19	48.43
Short Circuit Current	I _{sc} (A)	18.04	18.11	18.18	18.25	18.32	18.38	18.45
Voltage at Maximum Power	V _{mp} (V)	40.18	40.38	40.58	40.78	40.98	41.18	41.38
Current at Maximum Power	I _{mp} (A)	17.03	17.09	17.15	17.20	17.26	17.31	17.37

* Bifaciality Ratio: 80% ±10%

Mechanical Parameters

Cell	132 Half-Cut Cells
Cell Type	Monocrystalline / N-Type,
Dimension	2382×1134×30mm
Weight	33.2kg
Connector	PV-GZX1500, NINGBO GZX / PV-LY02, Yongan Anhui / PV-DA01M2-XY, DAS SOLAR Co., Ltd
Junction Box	IP68 rated, with 3 Diodes
Cable Length	4mm ² , Wire length of 300mm (customizable)
Front Glass	2.0mm Semi-tempered glass
Back Glass	2.0mm Semi-tempered glass

Temperature Characteristics

Nominal Operating Cell Temperature (NOCT)	42±2°C
Peak Power (P _{max}) Temperature Coefficient	-0.295%/°C
Open Circuit Voltage (V _{oc}) Temperature Coefficient	-0.257%/°C
Short Circuit Current (I _{sc}) Temperature Coefficient	+0.044%/°C

Limit Parameters

Operating Temperature	-40°C~+85°C
Maximum System Voltage	1500V DC (IEC)
Maximum Fuse Rating Current	30 A
Power Tolerance	0~+5W

Packaging Configuration

Module per box	36 pieces
Module per 40' container	720 pieces

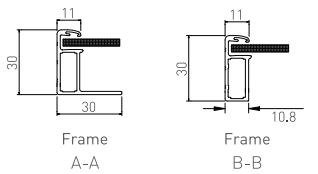
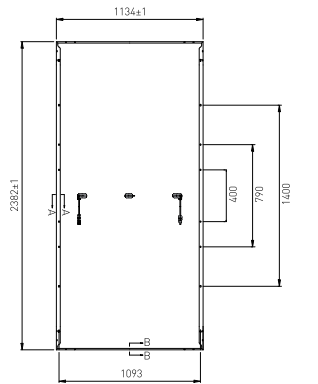
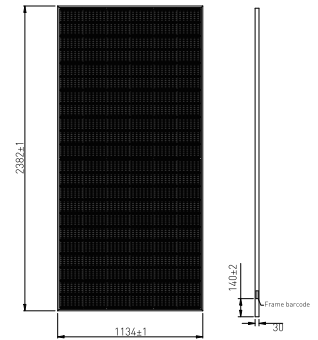
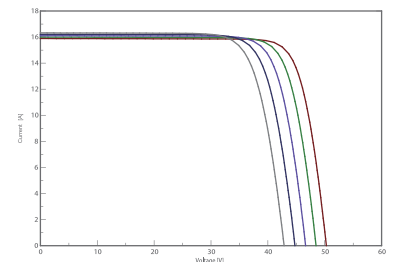
Module Dimensions

Curve Chart
I-V Curve at Different Temperature (625W)

I-V/P-V Curve at Different Irradiation (625W)
