

# SF- TOPCon SN54G3-2B

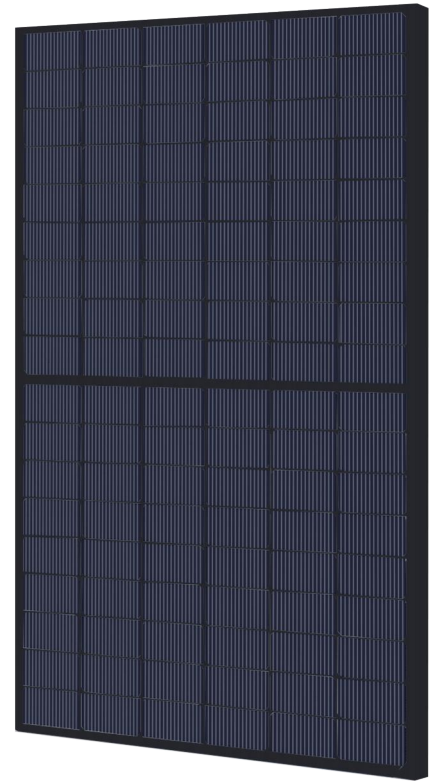

**N-Type Single-glass Monofacial All Black Solar Module**

Maximum Power Output **525W**

Maximum Module Efficiency **23.61%**

Power Tolerance **0~+5W**



#### MBB Half Cell

· High power output thanks to advanced 16-busbar technology and outstanding performance under real-life conditions.



#### Extreme Weather Rating

· High-tech aluminium frame, certified for snow loads (5400Pa) and wind loads (2400 Pa).



#### Innovative All-weather Technology

· Higher power output in low-light condition with excellent low-light and temperature behaviour.



#### A Reliable Investment

- Inclusive 15-year product warranty and 30-year linear performance warranty .
- Class C fire resistance test passed

### Industry-leading linear warranty

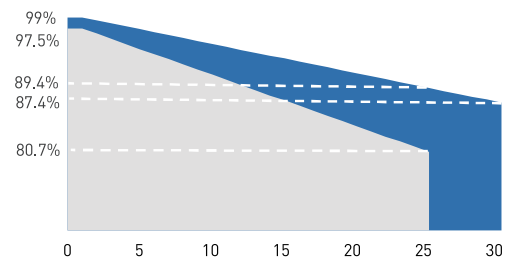

**1%**

First year degradation

**0.4%**

Annual degradation

**15 Year Product Warranty**

**30 Year Linear Power Output Warranty**

Note :

Certificate holder: Jiangsu Linyang Photovoltaic Technology Co., LTD.  
Country of Solar Module manufacture : China



**Electrical Parameters (STC)**

Maximum Power	P <sub>max</sub> (W)	490	495	500	505	510	515	520	525
Open Circuit Voltage	V <sub>oc</sub> (V)	39.27	39.62	39.82	39.98	40.27	40.63	40.82	41.18
Short Circuit Current	I <sub>sc</sub> (A)	15.55	15.61	15.67	15.73	15.79	15.84	15.90	15.96
Maximum Power Voltage	V <sub>mp</sub> (V)	32.87	33.04	33.20	33.37	33.53	33.69	33.86	34.02
Maximum Power Current	I <sub>mp</sub> (A)	14.92	15.00	15.07	15.15	15.23	15.30	15.38	15.45
Module Efficiency	(%)	22.03	22.26	22.48	22.71	22.93	23.16	23.38	23.61

\* Irradiance 1000W/m<sup>2</sup>, Cell Temperature 25°C, Air Mass 1.5, Testing Tolerance ±3%

**Electrical Specification (NOCT)**

Maximum Power	P <sub>max</sub> (W)	368	372	376	380	384	387	391	395
Open Circuit Voltage	V <sub>oc</sub> (V)	37.31	37.64	37.83	37.98	38.26	38.60	38.78	39.12
Short Circuit Current	I <sub>sc</sub> (A)	12.56	12.61	12.65	12.70	12.75	12.79	12.84	12.89
Voltage at Maximum Power	V <sub>mp</sub> (V)	30.63	30.78	30.93	31.09	31.24	31.39	31.54	31.70
Current at Maximum Power	I <sub>mp</sub> (A)	12.04	12.10	12.16	12.23	12.29	12.35	12.41	12.47

**Mechanical Parameters**

Cell	108 Half-Cut Cells
Cell Type	Monocrystalline / N-Type, 16BB
Dimension	1961×1134×30mm
Weight	22.1kg
Connector	PV-GZX500, NINGBO GZX/PV-LY02, Yongan Anhui/ PV-ZKC2, Shanxi Zhongke Anrui
Junction Box	IP68 rated, with 3 Diodes
Cable Length	4mm <sup>2</sup> , Wire length of 300mm (customizable)
Front Glass	3.2mm Semi-tempered glass
Back Panel	Black

**Temperature Characteristics**

Nominal Operating Cell Temperature (NOCT)	42±2°C
Peak Power (P <sub>max</sub> ) Temperature Coefficient	-0.295%/°C
Open Circuit Voltage (V <sub>oc</sub> ) Temperature Coefficient	-0.257%/°C
Short Circuit Current (I <sub>sc</sub> ) Temperature Coefficient	+0.044%/°C

**Limit Parameters**

Operating Temperature	-40°C~+85°C
Maximum System Voltage	1500V DC (IEC)
Maximum Fuse Rating Current	30A
Power Tolerance	0~+5W

**Packaging Configuration**

Module per box	36 pieces
Module per 40' container	864 pieces

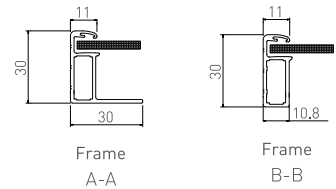
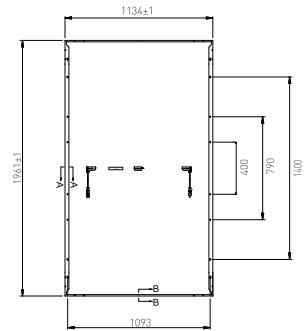
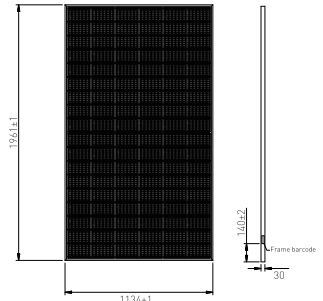
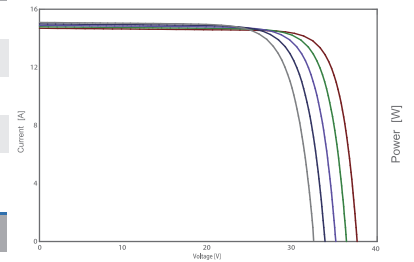
**Module Dimensions**

**Curve Chart**
**I-V Curve at Different Temperature (525W)**

**I-P/V Curve at Different Irradiation (525W)**
